

RRun-327

Marin Diesel

Cylinderblock

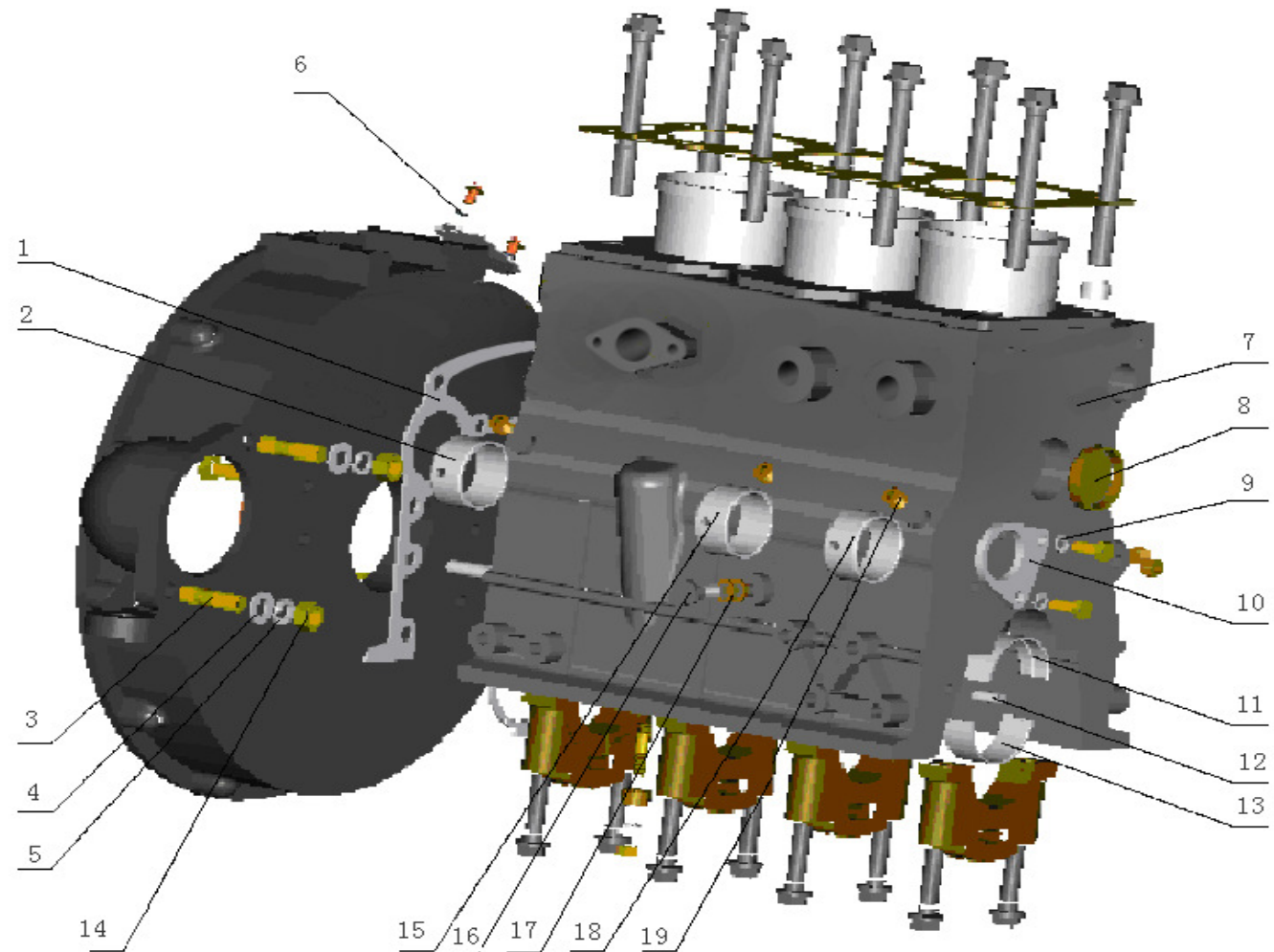

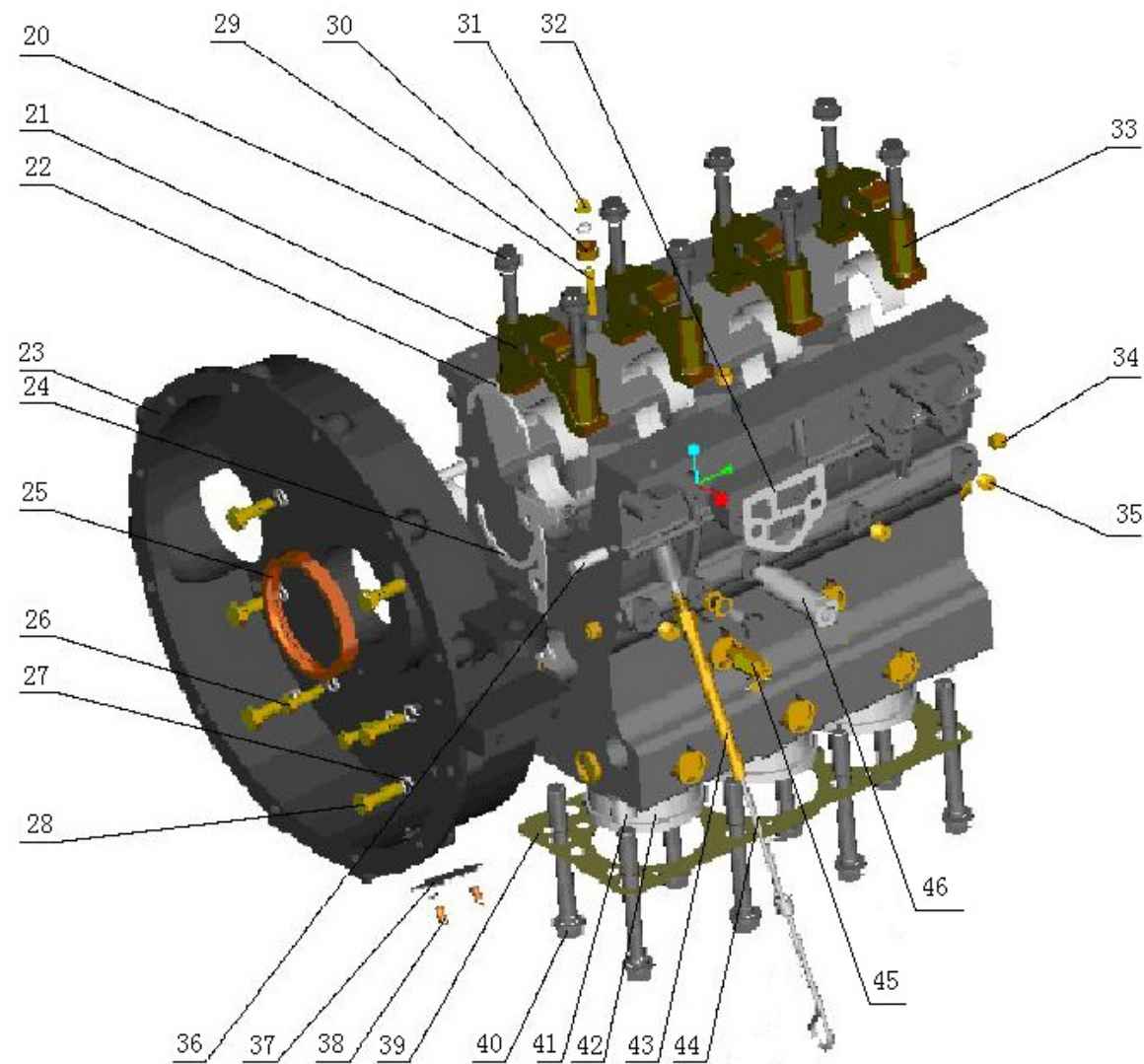

Nr	Reservdelsnummer	Namn	Antal	Varunummer
1	2308000100403	Packning	1	QC380Q—01004-2
2	2408000110801	Bakre kamaxellager	1	QC480Q—01108-1
3	M12×45	Bult M12x45	2	GB/T5783
4	Φ 12	Bricka Ø12	2	GB/T97.1
5	Φ 12	Bricka Ø12	2	GB/T93
6	Φ 6	Bricka Ø6	2	GB/T93
7	2308000110100	Cylinder block	1	QC380Q—01101
8	2408000110900	plugg	2	QC480Q-01109
9	Φ 8	Bricka Ø8	8	GB/T93
10	2408000101700	Kamaxellåsning	1	QC480Q—01017
11	2408000100100	Ramlager (övre)	5	QC480Q-01001
12	B8×20	Styr stift	1	GB/T119
13	2408000100200	Ramlager (nedre)	5	QC480Q—01002
14	M12	Mutter M12	2	GB/T6170
15	2408000110601	Kamaxellager (mittre)	1	QC480Q-01106-1
16	2410200201100	Plugg	2	4102Q-02011

17	Φ 10	Bricka Ø10	4	HG4-330-66
18	2408000110201	Främre kamaxellager	1	QC480Q-01102-1
19	1408500310900	Plug	3	N85Q-03110
20	2408000110501	Ramlagerbult	10	QC480Q-01105A
21	2408000110700	Bakre ramlageröverfall	1	QC480Q—01107
22	2408000100500	Axiallager (nedre)	2	QC480Q—01005
23	2408000100703	Svänghjulskåpa	1	QC480D—01007A
24	2408000100600	Axiallager (övre)	2	QC480Q—01006
25	FB80×100×12	Packbox FB80x100x12	1	GB/T9877.1
26	M8×30	Bult M8x30	2	GB/T5783
27	Φ 10	Bricka Ø10	6	GB/T93
28	M10×30	Bult M10x30	6	GB/T5783
29	M8×40	Pinnbult M10x30	1	GB/T898
30	2408000101800	Packning	1	QC480Q-01018
31	M8	Mutter M8	1	GB/T6170
32	1408500301700	Packning	1	N485Q-03020
33	2408000110300	Främre ramlageröverfall	4	QC480Q-01103
34	2409000101500	Plug	2	QC490Q(DI)-01015

35	2408000111000	Plug	3	QC480Q-01110
36	B10×20	Styr stift B10x20	2	GB/T119
37	2408000102100	Lock	1	QC480Q-01021
38	M6	Skruv M6	2	GB/T823
39	2308000100200	Cylinderhuvudpackning	1	QC380Q—01002
40	2408000101401	Cylinderhuvudbult	8	QC480Q—01014A
41	2408000101600	Rörstyrning	3	QC480Q-01016
42	2308000100100	Cylinderfoder	3	QC380Q—01001
43	2308000750001	Oljesticksrör	1	QC380Q-HB-01401A
44	2308000730001	Oljesticka	1	QC380Q-HB-01402A
45		Vattenavtappningskran	1	QC495T-01100
46	2408000130100	Anslutningsrör	1	QC480Q—01301

Transmission

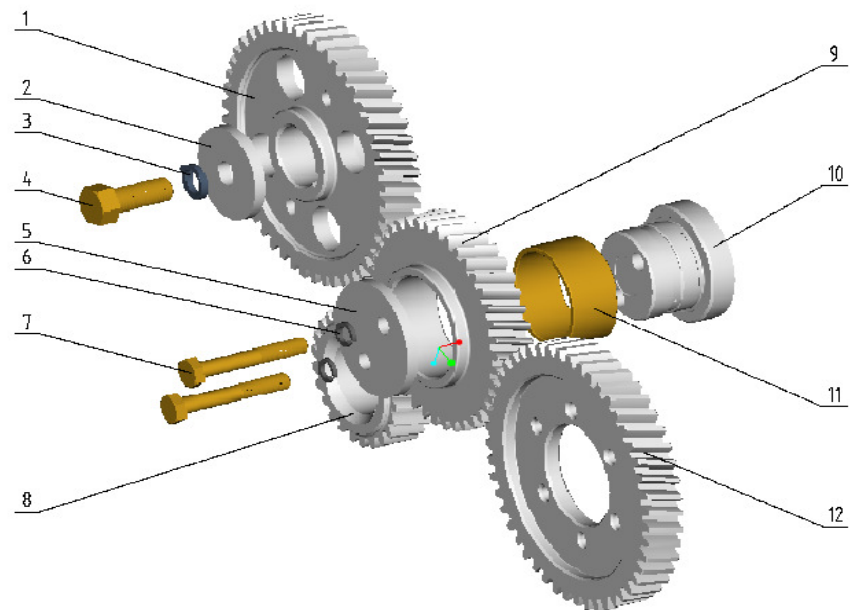

Nr	Reservdelsnr	Namn	Antal	Varunummer
1	2408000200600	Kamaxeldrev	1	QC480Q-02006
2	2408000200500	Fästbricka	1	QC480Q-02005
3	Φ 12	Bricka Ø12	1	GB/T93
4	M12 × 30	Bult M12x30	1	GB/T5783
5	2408000200400	Fästbricka	1	QC480Q-02004
6	Φ 8	Bricka Ø8	2	GB/T93
7	M8 × 55	Bult M8x55	2	GB/T5783
8	2408000200300	Vevaxeldrev	1	QC480Q-02003
9	2408000210100	Mellanaxeldrev	1	QC480Q-02101
10	2408000200200	Mellanaxel	1	QC480Q-02002
11	2408000210200	Mellanaxellager	1	QC480Q-02102
12	2308000200101	Bränslepumpdrev	1	QC380Q—02001A

Cylinderhuvud

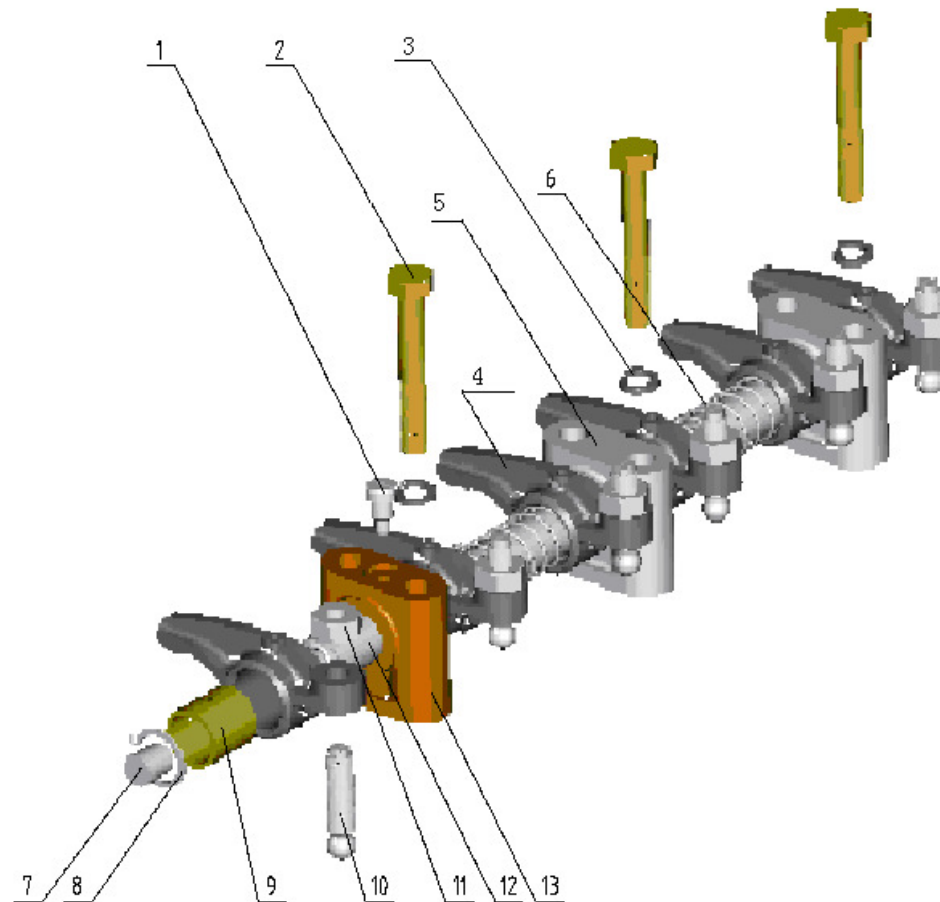

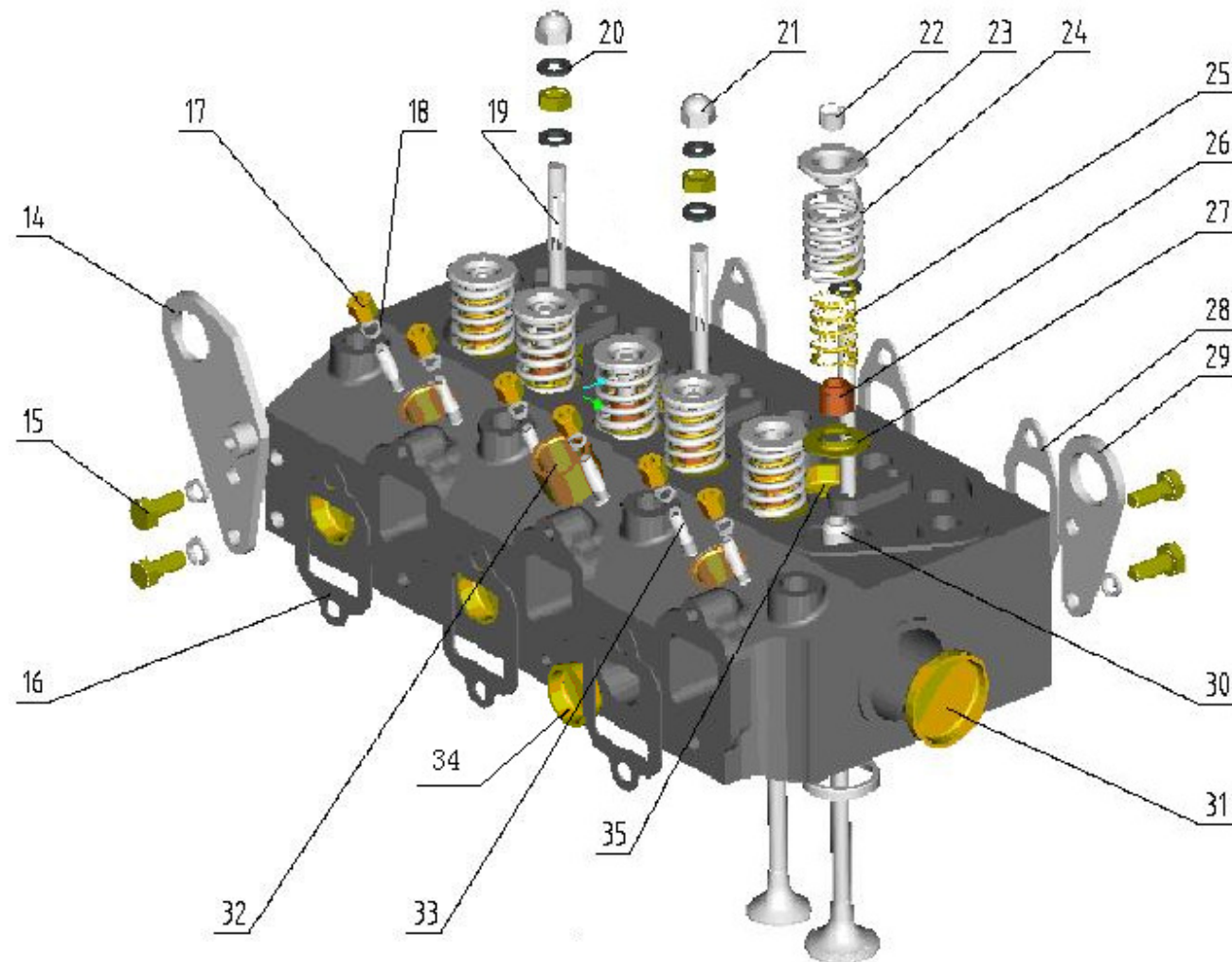

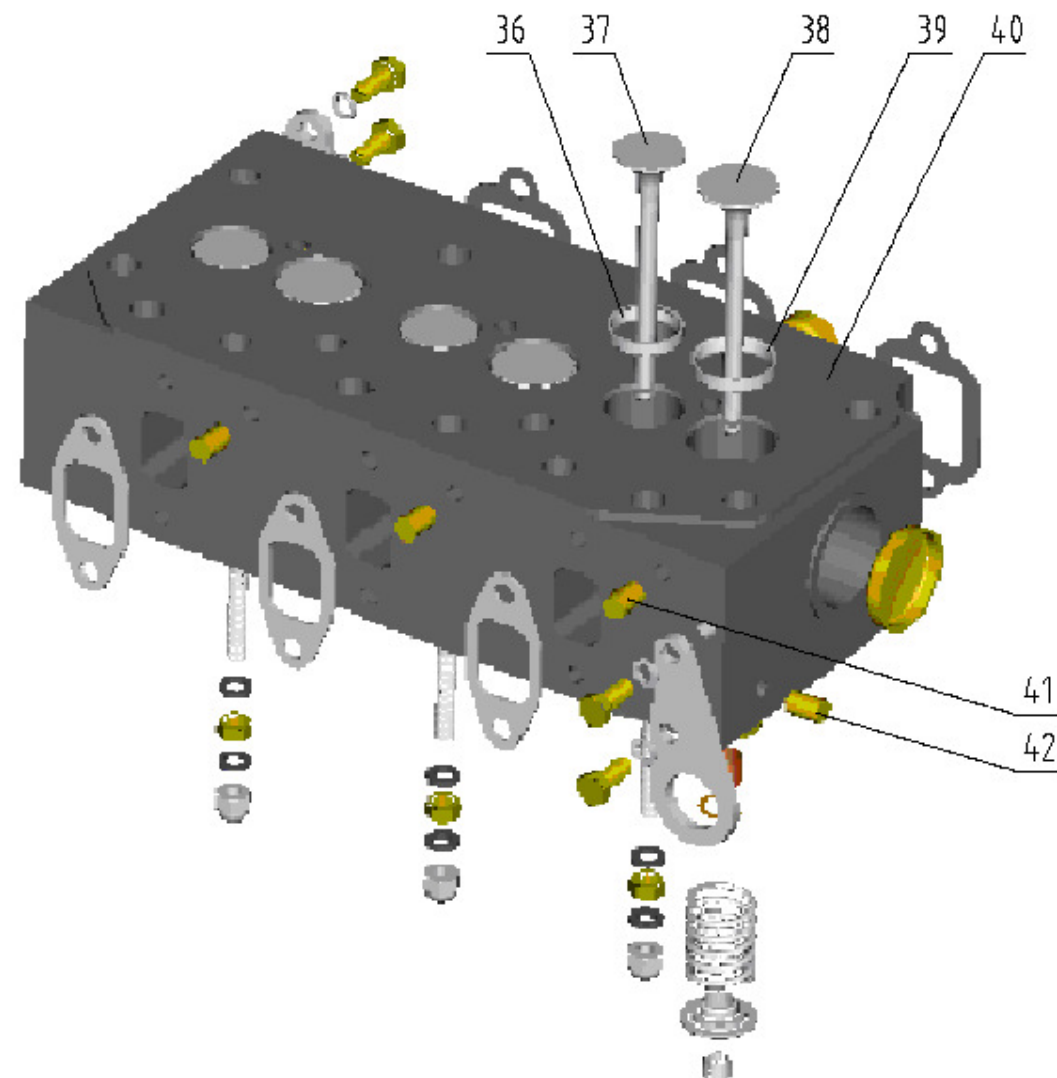

Nr	Reservdelsnr	Namn	Antal	Varunummer
1	2408000320500	Vipparmsskruv	1	QC480Q-03205
2	M8×55	Bult m8x55	3	GB/T5783
3	Φ 8	Bricka Ø8	9	GB/T93
4	2408000320300	Vipparm	6	QC480Q-03203
5	2408000320200	Vipparmsfäste	3	QC480Q-03202
6	2408000320400	Fjäder	3	QC480Q-03204
7	2408000321200		2	QC480Q-03212
8		Låsring	2	GB/T894.1
9	2408000320700	Vipparmslager	6	QC480Q-03207
10	2408000320100	Justerskruv	6	QC480Q-03201
11	M8	Mutter M8	6	GB/T6170
12	2308000320100	Vipparmsaxel	1	QC380Q—03201
13	2408000320600	Bakre vipparmsaxel fäste	1	QC480Q-03206
14	2408000300400	Lyftögla	1	QC480Q—03004
15	M8×20	Bult M8x20	3	GB/T5783
16	2408000300901	Packning	3	QC480Q-03009
17	2408000301000	Spridar muttrar	6	QC480Q-03010

18	Φ 6	Bricka Ø6	6	GB/T9783
19	2408000300500	Vipparmsbultar	6	QC480Q-03005
20	Φ 8	Bricka Ø8	3	HG4-330-66
21	M8	Bult M8	3	GB/T923
22	1408500200200	Ventilskaftlås	6	N485-02002
23	1408500200100	Ventilbricka	6	N485-02001
24	1408500200300	Yttre ventilmfjäder	6	N485-02003
25	1408500201000	Inre ventilmfjäder	6	N485-02013
26	1408500201100	Vetiltätning	6	N485-02014
27	2408000300200	Nedre ventilmfjädersäte		QC480Q-03002
28	2408000300300	Avgasgrenrörspackning	3	QC480Q—03003
29	2408000300600	Lyftögla	1	QC480Q—03006
30	2408000310300	Ventilstyrning	6	QC480Q—03103
31	2408000110900	Plugg	1	QC480Q-01109
32		Spridarsäte		QC480Q-03102
33	2408000300100	Spridarbult	6	QC480Q-03001
34	2408000310900	Plugg	3	QC480Q-03109
35		Plugg		QC480Q-03104

36	2408000310500	Avgasventilsäte	3	QC480Q—03105
37	2408000300800	Avgasventil	3	QC480Q—03008
38	2408000300700	Insugsventil	3	QC480Q—03007
39	2408000310600	Insugsventilsäte	3	QC480Q—03106
40	2308000310101	Cylinderhuvud	1	QC380Q—03101
41	2408000310700	Plugg	3	QC480Q-03107
42	2408000311000	Pugg	1	QC480Q-03110-1

Kolv och vevstake

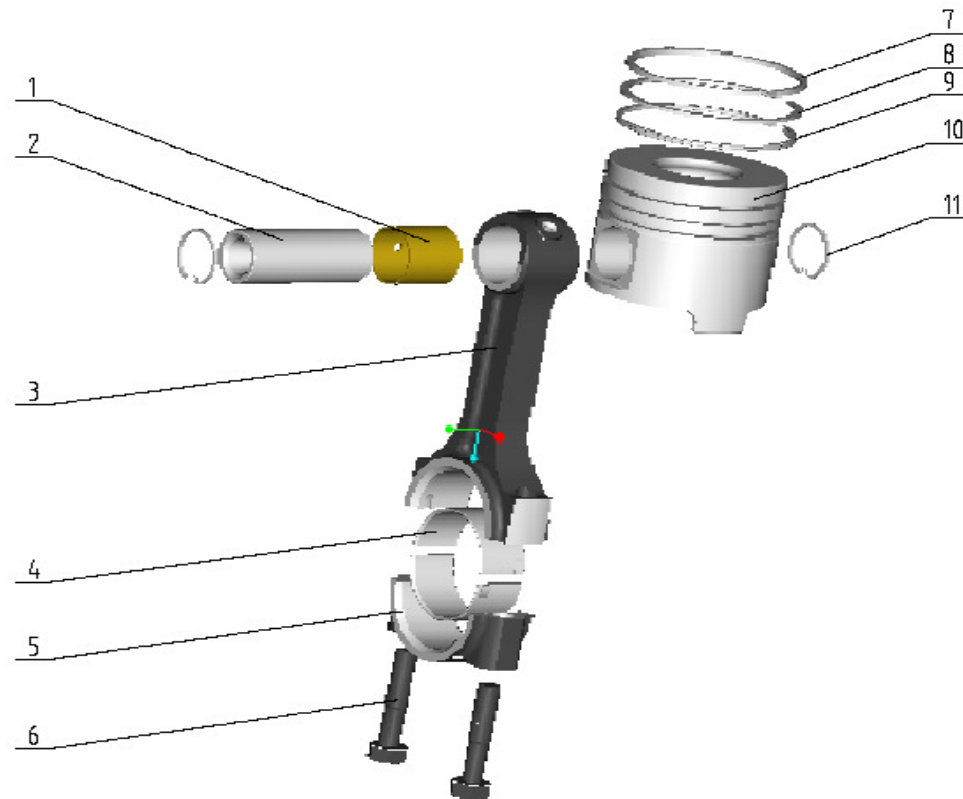

Nr	Reservdelsnr	Namn	Antal	Varunummer
1	2408000420101	Kolvbultlager	3	QC480Q—04201B
2	2408000400401	Kolvbult	3	QC480Q—04004
3	2408000420200	Vevstake	3	QC480Q—04202
4	2408000420500	Vevlager	6	QC480Q—04205
5	2408000420300	Vevlageröverfall	3	QC480Q—04203
6	2408000420400	Överfallsbult	6	QC480Q—04204
7	2408000400200	Övre kolvring	3	QC480Q—04002
8	2408000400300	Mellersta kolvring	3	QC480Q—04003
9	2408000410000	Oljering	3	QC480Q—04100
10	2408000400101	Kolv	3	QC480Q—04001B
11	Φ 28	Låsring	6	GB/T893.1

Vevaxel

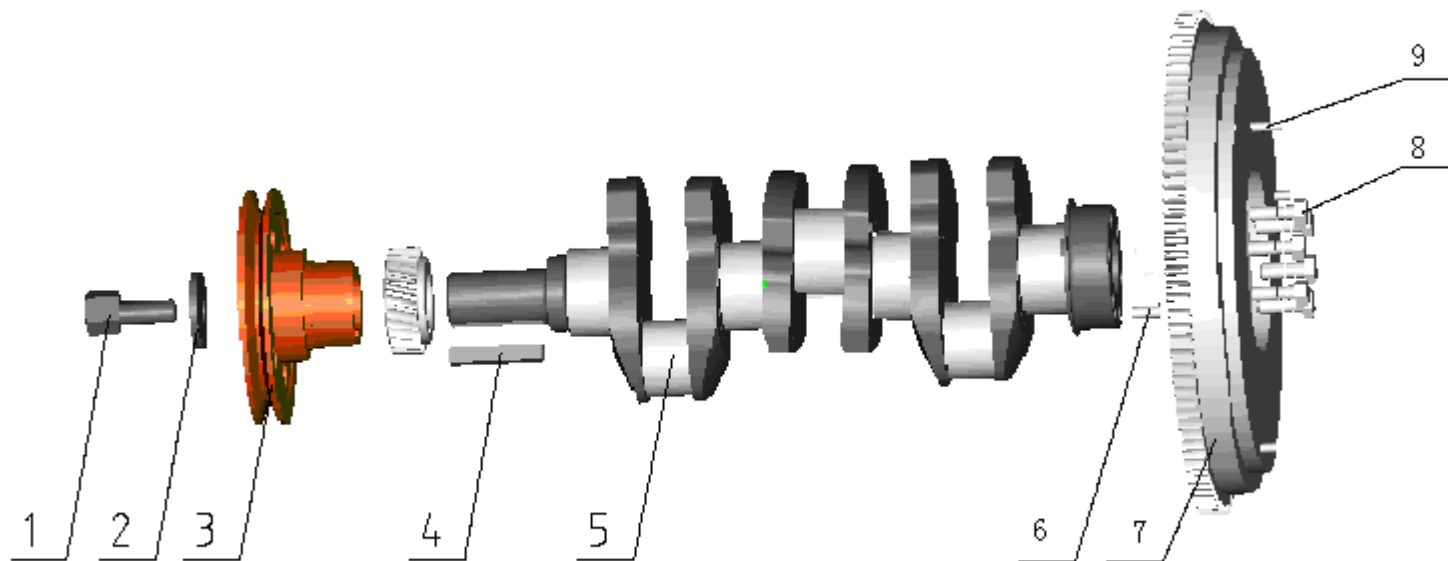

Nr	Reservdelsnr	Namn	Antal	Varunummer
1	2408000500201	Bult	1	QC480Q-05002A
2	2408000500300	Bricka	1	QC480Q-05003
3	2308000500100	Remskiva	1	QC380Q-05001
4	C10×63	Krysskil C10x63	1	GB/T1096
5	2308000500401	Vevaxel	1	QC380Q-05004A
6	B8×20	Styrstift B8x20	1	GB/T119.1
7	2308000510204	Svänghjul	1	QC380D-05102
8	2408000500600	Bult	6	QC480Q-05006
9	B6×20	Styrstift B6x20	3	GB/T119.1

kamaxel

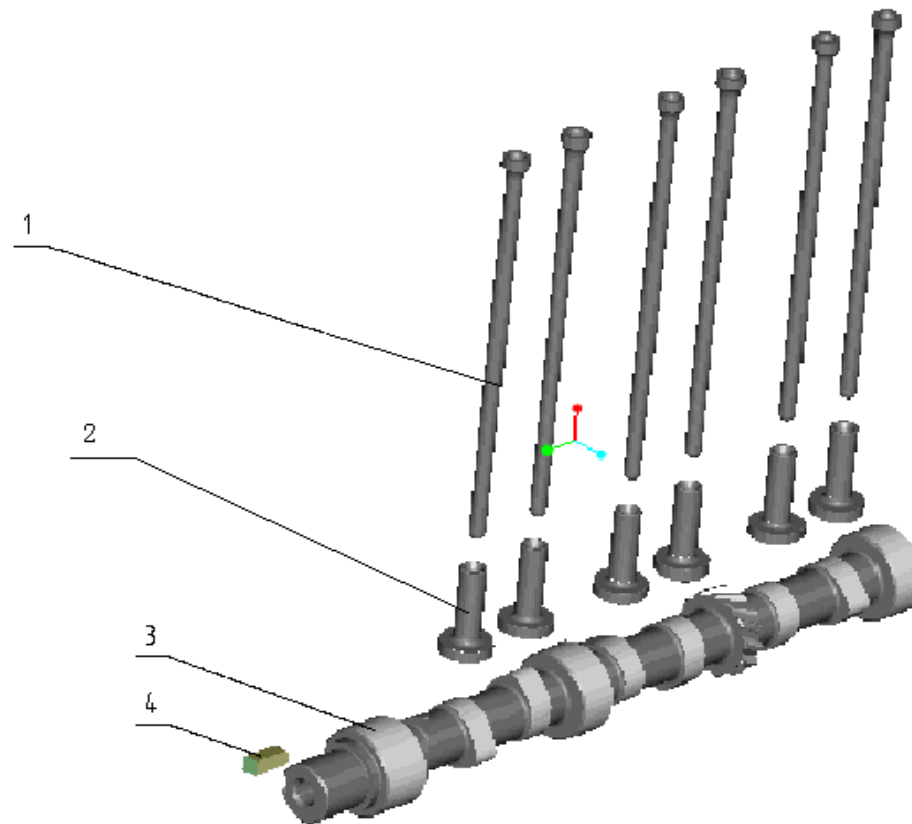

Nr	Reservdelsnr	Namn	Antal	Varunummer
1	2408000600300	Stötstång	6	QC480Q-06003
2	2408000600200	Lyftare	6	QC480Q-06002
3	2308000600100	Kamaxel	1	QC380Q—06001
4	C8×22	Krysskil C8x22	1	GB/T1096

Oljesump

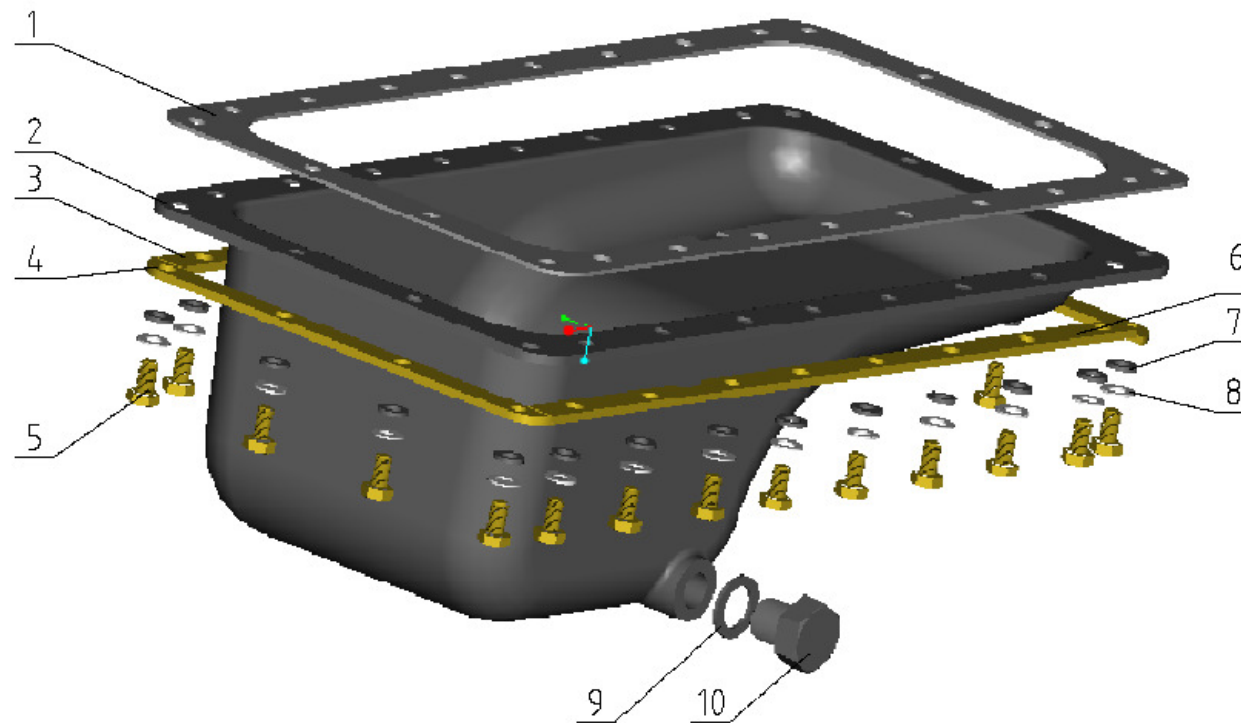

Nr	Reservdelsnr	Namn	Antal	Varunummer
1	2308000700100	Packning	1	QC380Q—07001
2	2308000710001	Oljesump	1	QC380Q—07100-1
3	2308000700300	Tryckutjämnare	1	QC380Q—07003
4	2408000700400	Tryckutjämnare	1	QC480Q-07004
5	M8×15	Bult M8x15	20	GB/T5783
6	2308000700200	Tryckutjämnare	1	QC380Q—07002
7	Φ 8	Bricka Ø8	20	HG4-330-66
8	Φ 8	Bricka Ø8	20	GB/T97.1
9	JB/T982	Tätring	2	N85-11002
10		Avtappningsplugg	1	4102D-13003

Avgasgrenrör

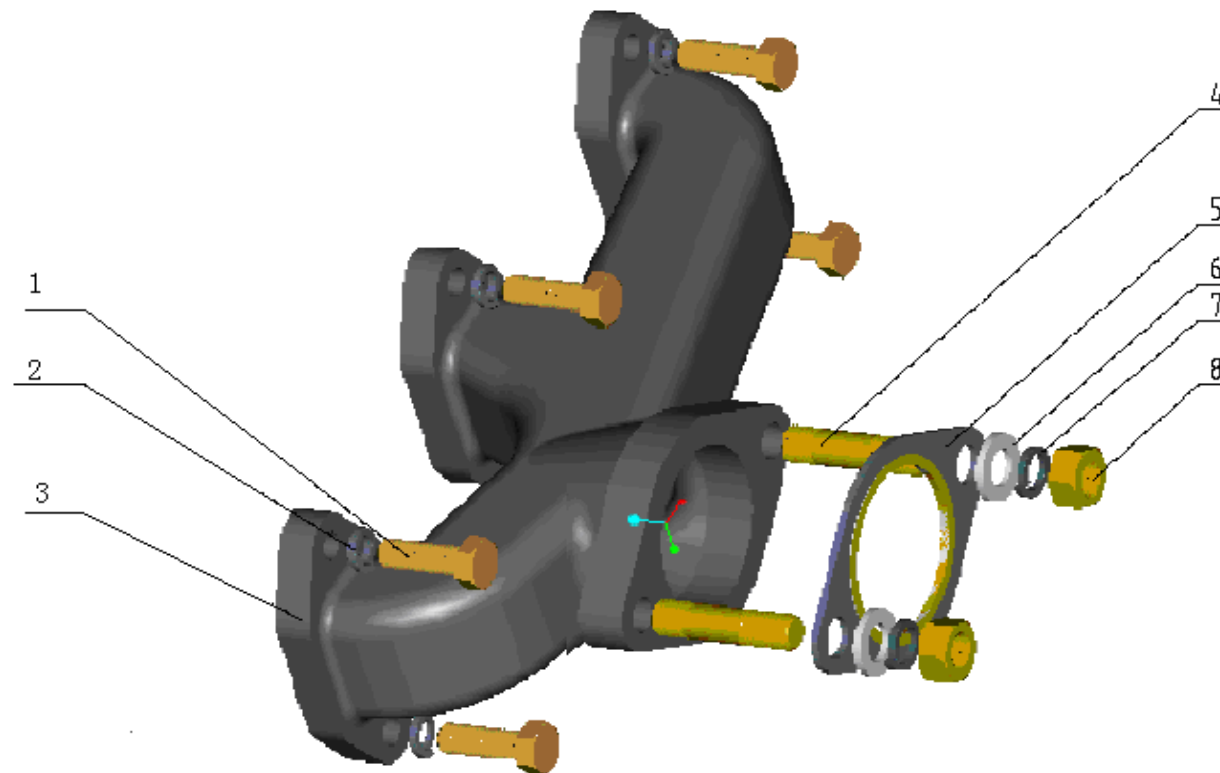

Nr	Reservdelsnr	Namn	Antal	Varunummer
1	M8×25	Bult M8x25	6	GB/T5783
2	Φ 8	Bricka Ø8	6	GB/T93
3	2308000800101	Avgasgrenrör	1	QC380Q—08001-1
4	M10×40	Pinnbult M10x40	2	GB/T898
5	2308000800200	Packning	1	QC380Q—08002
6	Φ 10	Bricka Ø10	2	GB/T97.1
7	Φ 10	Bricka Ø10	2	GB/T93
8	M10	Mutter M10	2	GB/T6170

Insugningsgrenrör

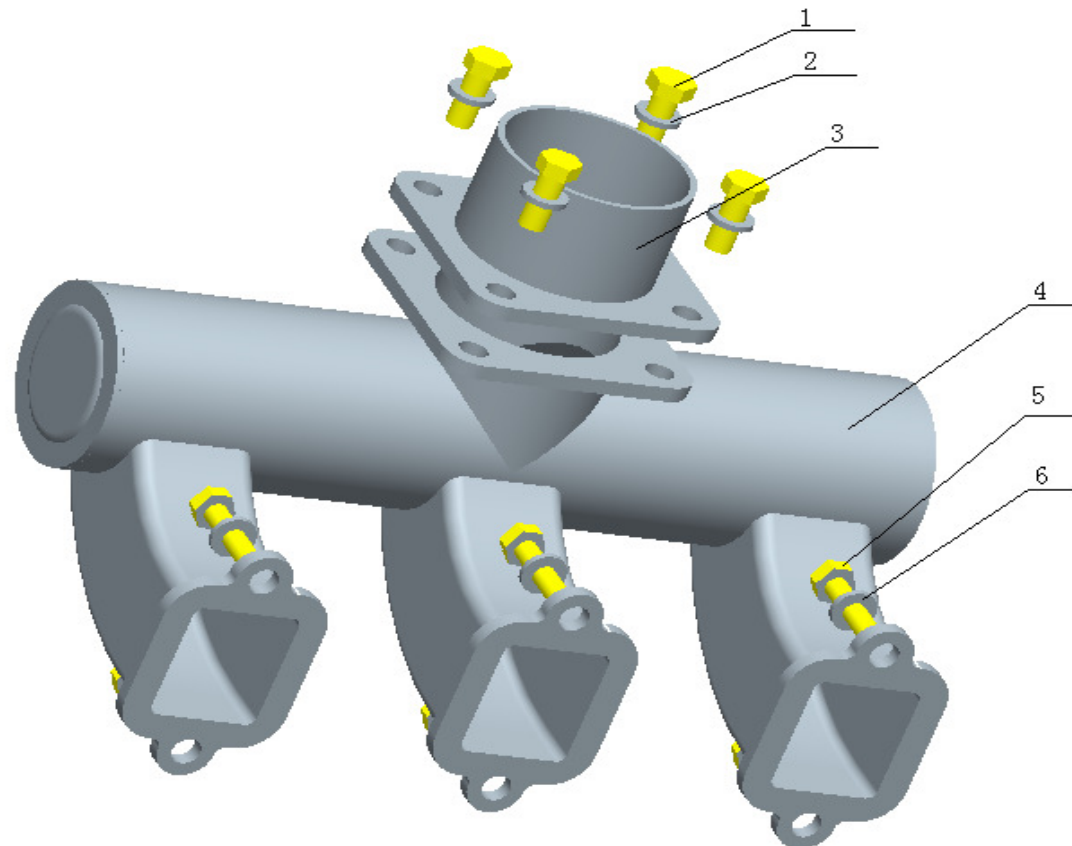

Nr	Reservdelsnr	Namn	Antal	Varunummer
1	M8×20	Bult M8x20	4	GB/T5783
2	Φ 8	Bricka Ø8	1	GB/T93
3	1408500900209	Anslutningsrör	1	N485BG-09005
4	2308000910003	Insugningsgrenrör	1	QC380D-09000
5	M8×35	Bult M8x35	6	GB/T5783
6	Φ 8	Bricka Ø8	6	GB/T93

Ventilkåpa

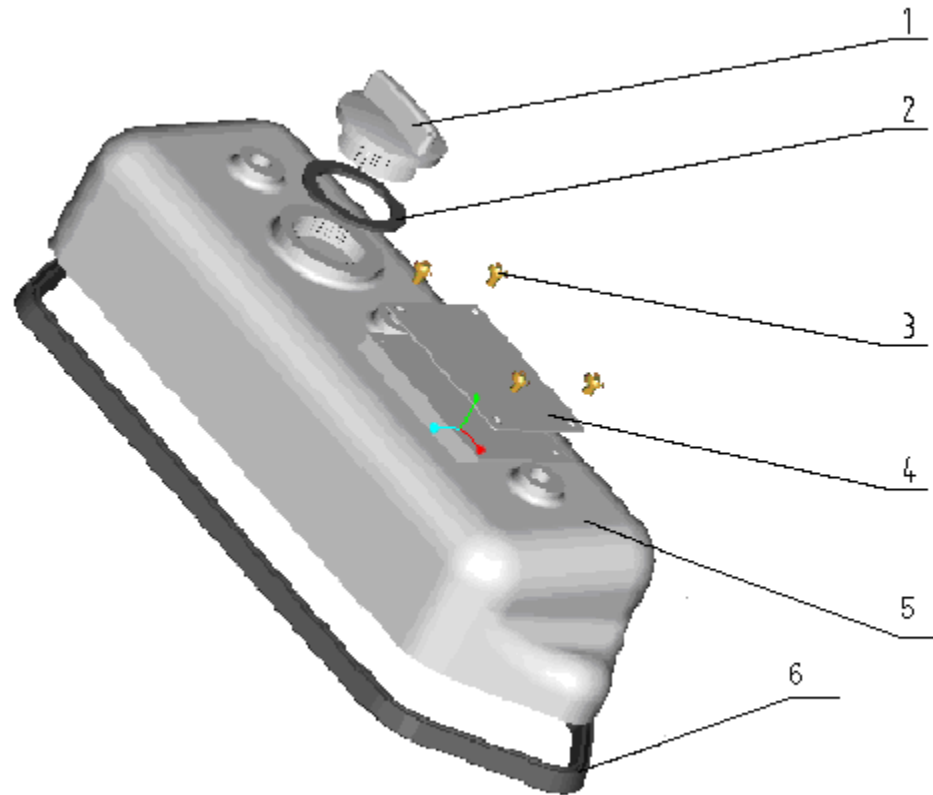

Nr	Reservdelsnr	Namn	Antal	Varunummer
1	1408500120000	Oljepåfyllningslock	1	N85-01100
2		Tätring	1	GB/T3452.1
3	M4	Skruv M4	4	GB/T823
4	2308001100200	ID skylt	1	QC380Q—11002
5	2308001100100	Ventilkåpa	1	QC380Q—11001
6	2308001100401	Packning	1	QC380Q—11004A

Transmission

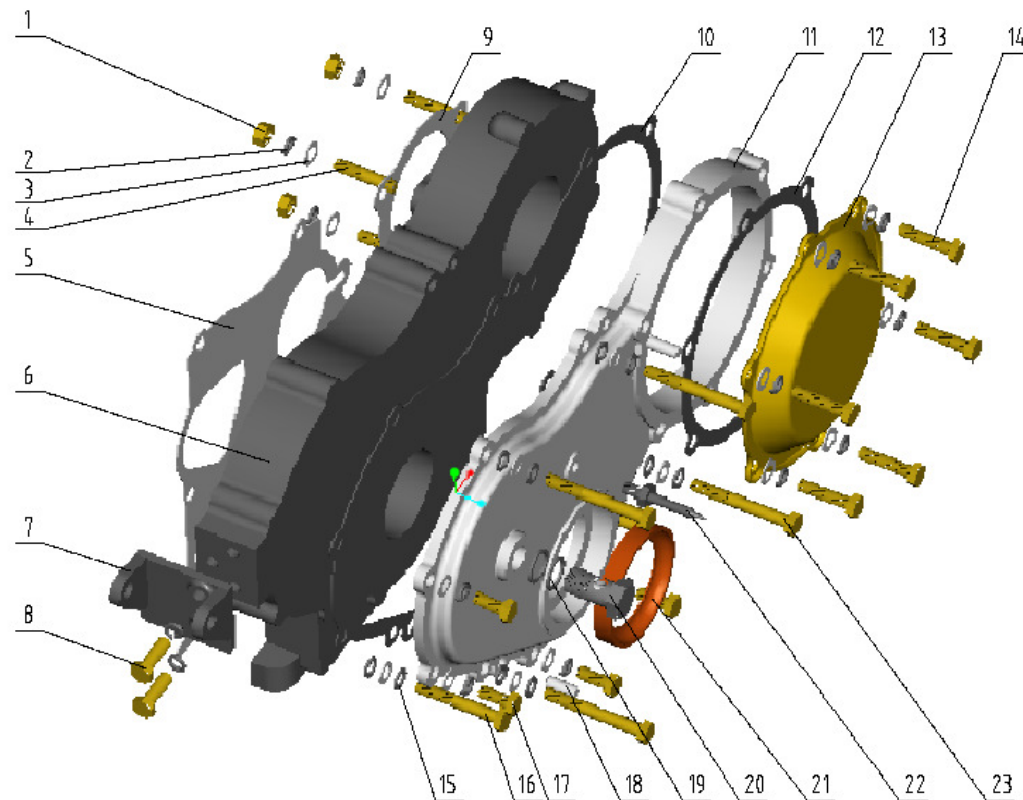

Nr	Reservdelsnr	Namn	Antal	Varunummer
1	M8	Mutter M8	3	GB/T6170
2	Φ 8	Bricka Ø8	15	GB/T93
3	Φ 8	Bricka Ø8	15	GB/T97.1
4	M8×40	Pinnbult M8x40	3	GB/T898
5	2408001200600	Packning	1	QC480Q-12006
6	2408001200500	transmissionshus	1	QC480Q-12005
7	2308001200100	Generatorfäste	1	QC380Q—12001
8	M8×25	Bult M8x25	2	GB/T5783
9	2408001200700	Packning	1	QC480Q-12007
10	2408001200400	Packning	1	QC480Q-12004
11	2408001200300	Transmissionskåpa	1	QC480Q-12003
12	2408001200200	Packning	1	QC480Q-12002
13	2408001200101	Kåpa (insprutningspump)	1	QC480Q-12001
14	M8×35	Bult M8x25	6	GB/T5783-2000
15	Φ 8	Bricka Ø8	12	HG4-330-66
16	M8×55	Bult M8x25	2	GB/T5782
17	M8×20	Bult M8x20	4	GB/T5783

18	B8×20	Styrstift B8x20	1	GB/T119
19	Φ 16	Bricka Ø16	2	HG4-330-66
20	2410200203600	Bult	1	4102Q-02036
21	DR55×75×12	Packbox DR55x75x12	1	HG4-692-67
22	2408001201000	Noll lägesindikering	1	QC480Q-12010
23	M8×65	Bult m8x65	4	GB/T5782

Spridarrör

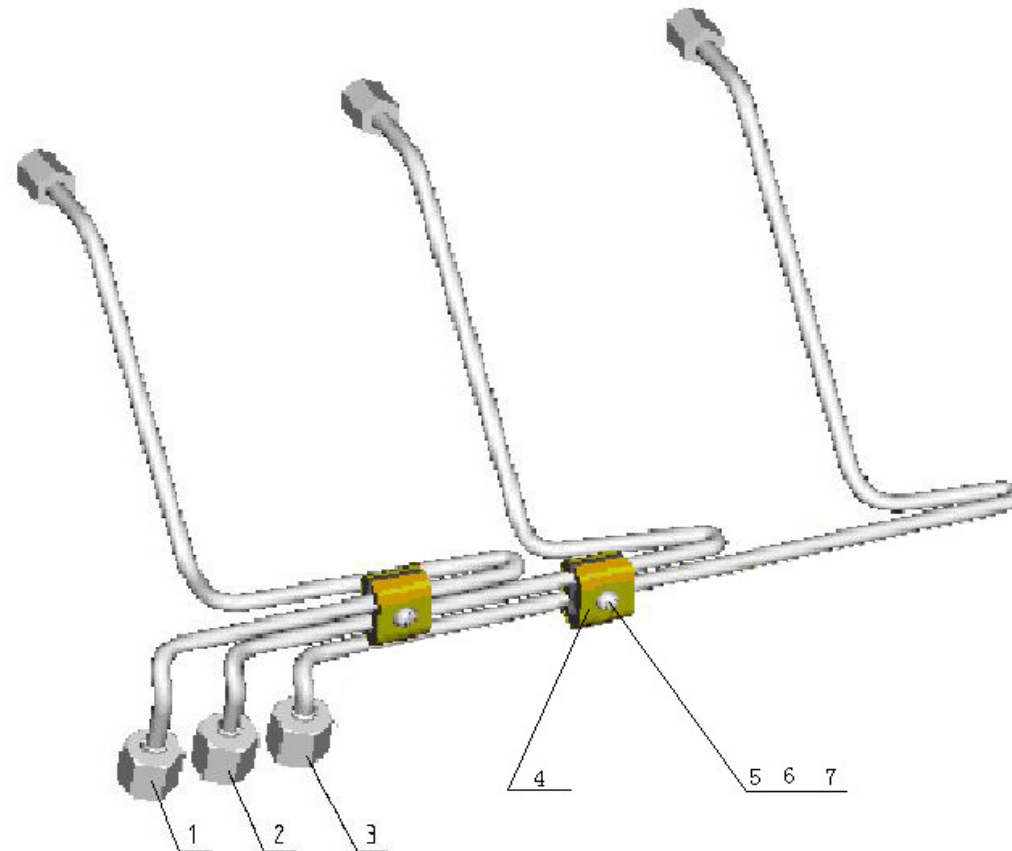

Nr	Reservdelsnr	Namn	Antal	Varunummer
1	2408001410000	1 cyl spridarrör	1	QC480Q—14100
2	2408001420000	2cyl spridarrör	1	QC480Q—14200
3	2408001430000	3cyl spridarrör	1	QC480Q—14300
4	1408501400100	rörhållare	2	N85-14001
5	M5×20	Bult M5x20	2	GB/T823
6	∅ 5	Bricka Ø5	2	GB/T859
7	M5	Mutter M5	2	GB/T6170

Oljepump

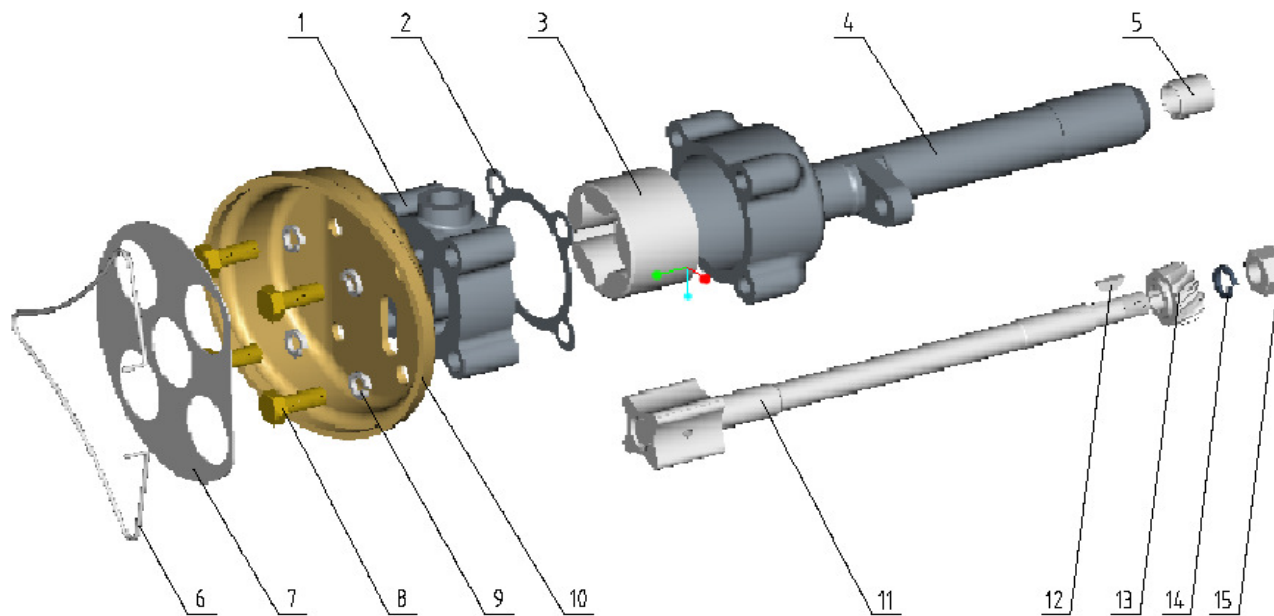

Nr	Reservdelsnr	Namn	Antal	Varunummer
1	2308001500200	Pumphalva	1	QC380Q-15002
2	2308001500300	Packning		QC380Q-15003
3	2308001500700	Yttre pumpdrev	1	QC380Q-15007
4	2308001500100	Pumphus	1	QC380Q-15001
5	2308001500600	Busning	1	QC380Q-15006
6	2308001520100	Låsring	1	QC380Q-15201
7	2308001520200	Filterhållare	1	QC380Q-15202
8	M8 × 20	Bult M8×20	4	GB/T5783
9	∅ 8	Bricka Ø8	4	GB/T93
10	2308001520300	Filterhus	1	QC380Q-15203
11	2308001510000	Pumpaxel	1	QC380Q-15100
12	3 × 13	Krysskil 3×5×13	1	GB/T1099
13	2408001510100	Drev	1	QC480Q-15101
14	∅ 10	Bricka Ø10	1	GB/T93
15	M10	Mutter M10	1	GB/T6170

Vevhusventilation

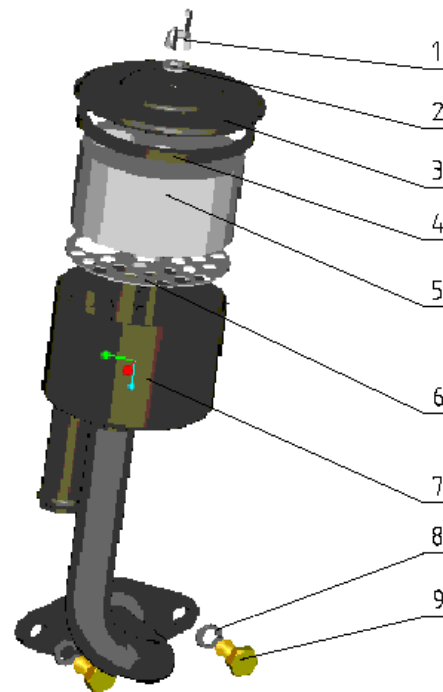

Nr	Reservdelsnr	Namn	Antal	Varunummer
1	M6	Vingmutter M6	1	GB/T62
2	Ø 6	Bricka Ø6	1	GB/T97.1
3	2408001600300	Lock	1	QC480Q-16003
4	2408001600400	Packning	1	QC480Q-16004
5	2408001600201	Insatts	1	QC480Q-16002A
6	2408001600101	Galler	1	QC480Q-16001A
7	2308001610001	Hus	1	QC380Q-16100A
8	Ø 8	Bricka Ø8	2	GB/T93
9	M8 × 20	Bult M8x20	2	GB/T5783

Oljerör

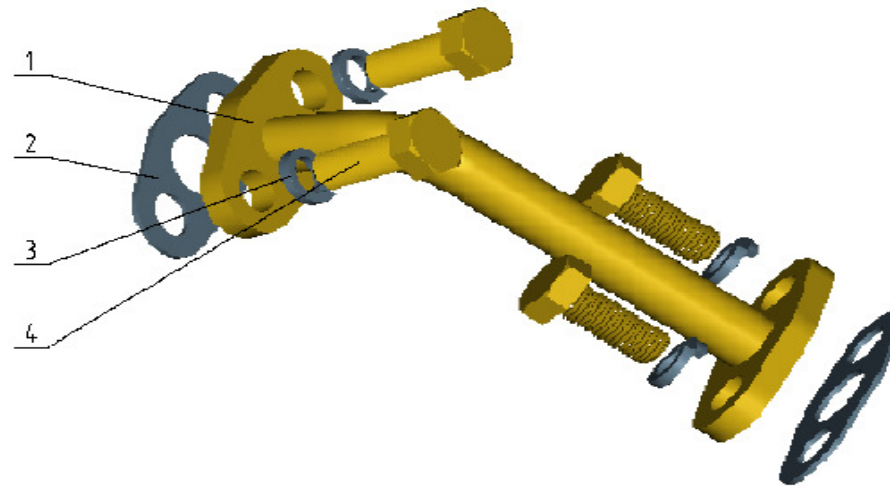

nr	Reservdelsnr	Namn	Antal	Varunummer
1	2308001700100	Oljerör	1	QC380Q—17001
2	2408001700101	Packning	1	QC480Q—17001
3	∅ 8	Bricka Ø8	4	GB/T93
4	M8×20	Bult M8x20	4	GB/T5783

Vattenpump och fläkt

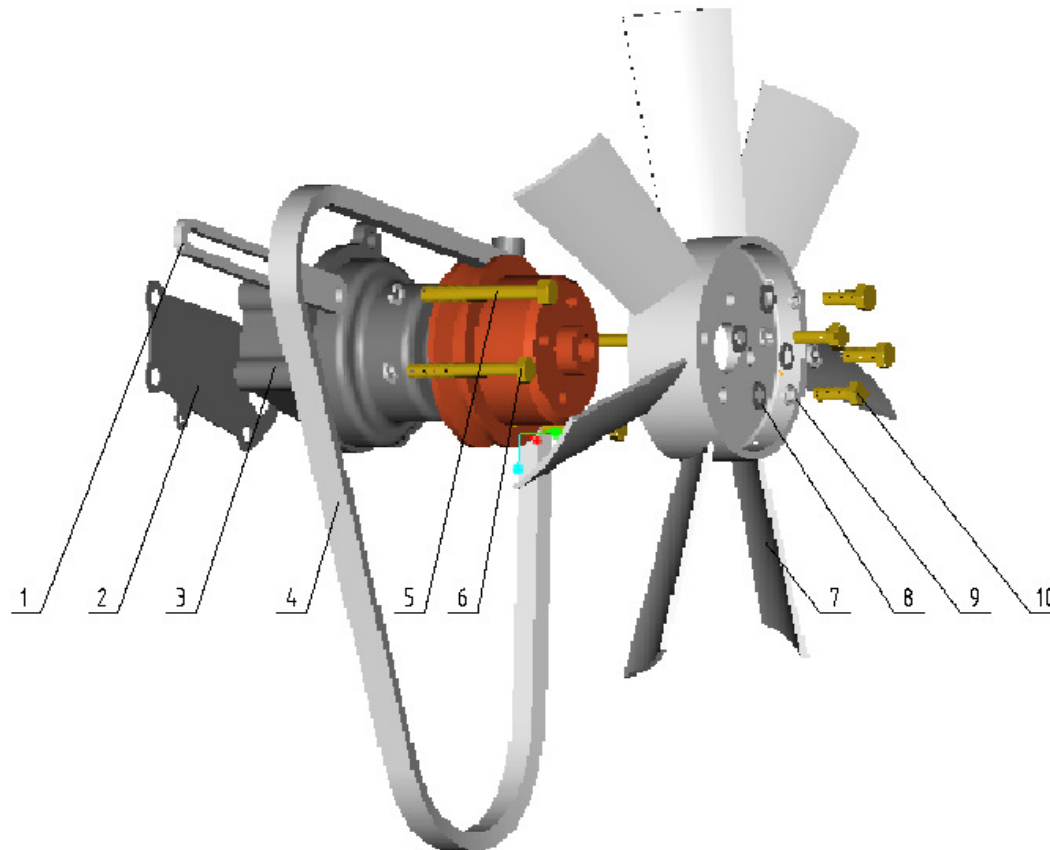

Nr	Reservdelsnr	Namn	Antal	Varunummer
1	2308001800200	Generatorjusteringsstag	1	QC380Q—18002
2	2308001800100	Packning	1	QC380Q—18001
3	2308001810000	Vattenpump	1	QC380Q—18100
4	965mm; A	Generatorrem (965mm)	1	GB/T1154
5	M8×65	Bult M8x65	1	GB/T5782
6	M8×60	Bult M8x60	3	GB/T5782
7	1408500800100	Fläkt Ø290	1	N85Q—08001
8	Ø 8	Bricka Ø8	4	GB/T97.1
9	Ø 8	Bricka Ø8	8	GB/T93
10	M8×20	Bult M8x20	4	GB/T5783

Termostathus

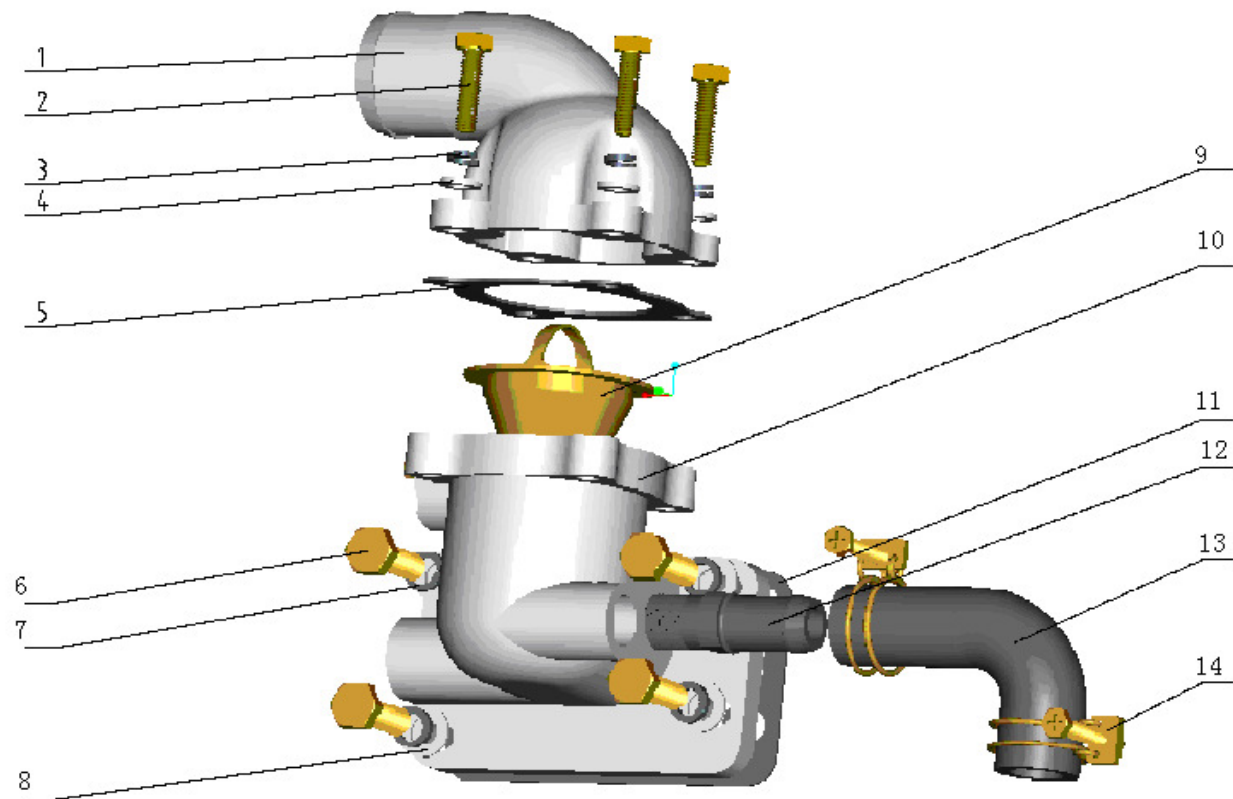

Nr	Reservdelsnr	Namn	Antal	Varunummer
1	2408001900300	Termostathuslock	1	QC480Q-19003
2	M6×25	Bult m6x25	4	GB/T5783
3	∅ 6	Bricka Ø6	4	GB/T93
4	∅ 6	Bricka Ø6	4	GB/T97.1
5	2408001900400	Packning	1	QC480Q-19004
6	M8×25	Bult M8x25	4	GB/T5783
7	∅ 8	Bricka Ø8	4	GB/T93
8	∅ 8	Bricka Ø8	4	GB/T97.1
9	2408001900200	Termostat	1	QC480Q-19002
10	2408001900500	Termostathus	1	QC480Q-19005
11	2408001900600	Packning	1	QC480Q-19006
12	2408001900700	Röranslutning	1	QC480Q-19007
13	2408001900100	Slang	1	QC480Q-19001
14	∅ 24	Slangklämma Ø24	2	QC/T390

Generator

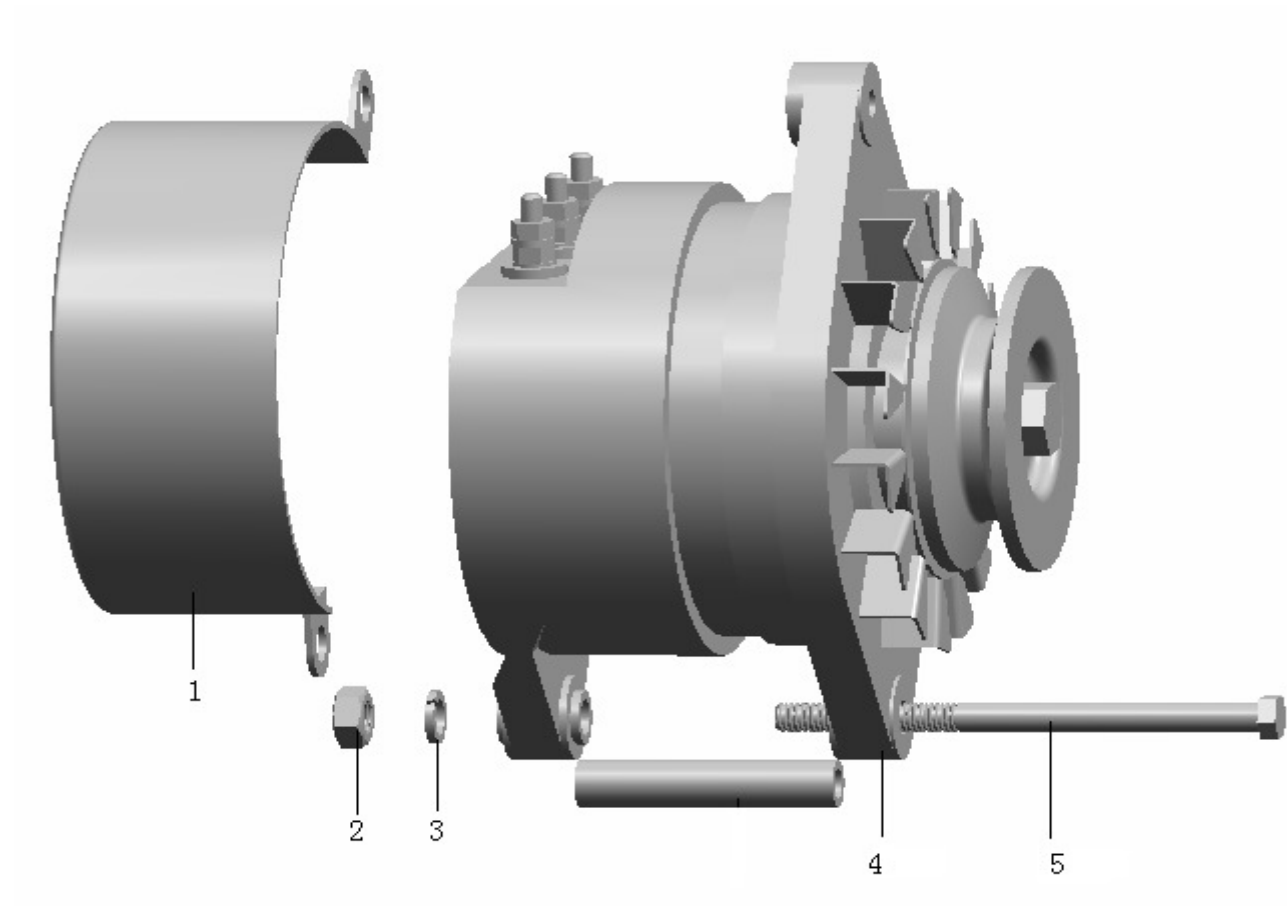

Nr	Reservdelsnr	Namn	Antal	Varunummer
1	2408002150000	Skydd	1	QC480D—KW—007
2		Mutter M10	1	GB/T6170
3	Ø 10	Bricka Ø10	1	GB/T859
4		Generator (JFWZ15Y)	1	350W/14V
5	M10×135	Bult M10×135	1	GB/T5783

Startmotor

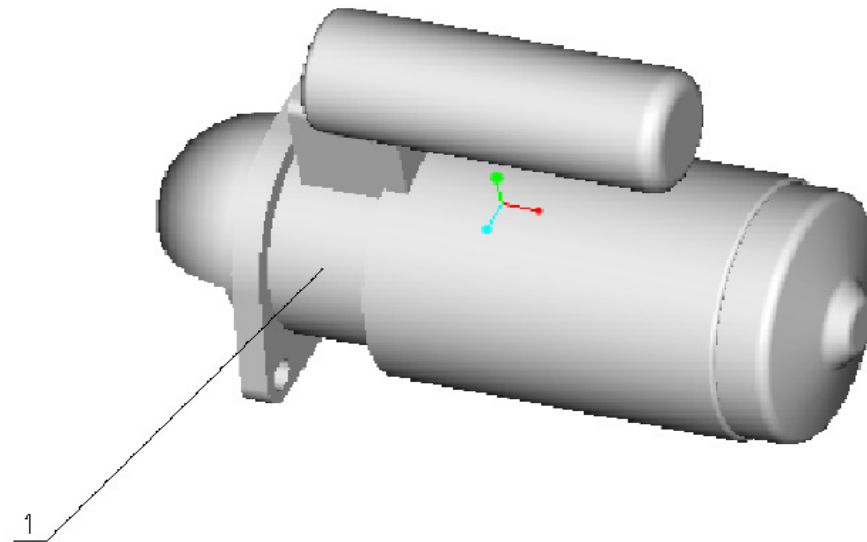

Nr	Reservdelsnr	Namn	Antal	Varunummer
1	2308002200000	Startmotor (QDJ138Y,12V/3Kw)	1	QC380Q-22000

bränslefilterhållare

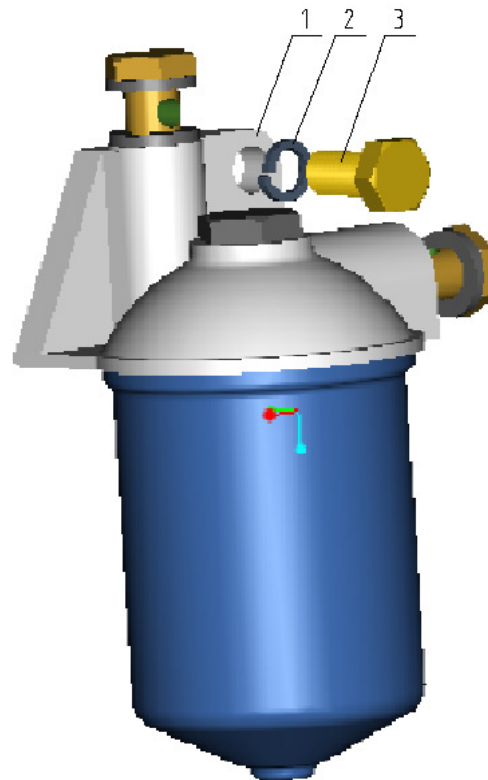

Nr	Reservdelsnr	Namn	Antal	Varunummer
1	2408002310002	Bränslefilter (C0506D)	1	QC480Q-23100B
2		Bricka Ø10	1	GB/T93
3		Bult M10×25	1	GB/T5783

Bränslerör

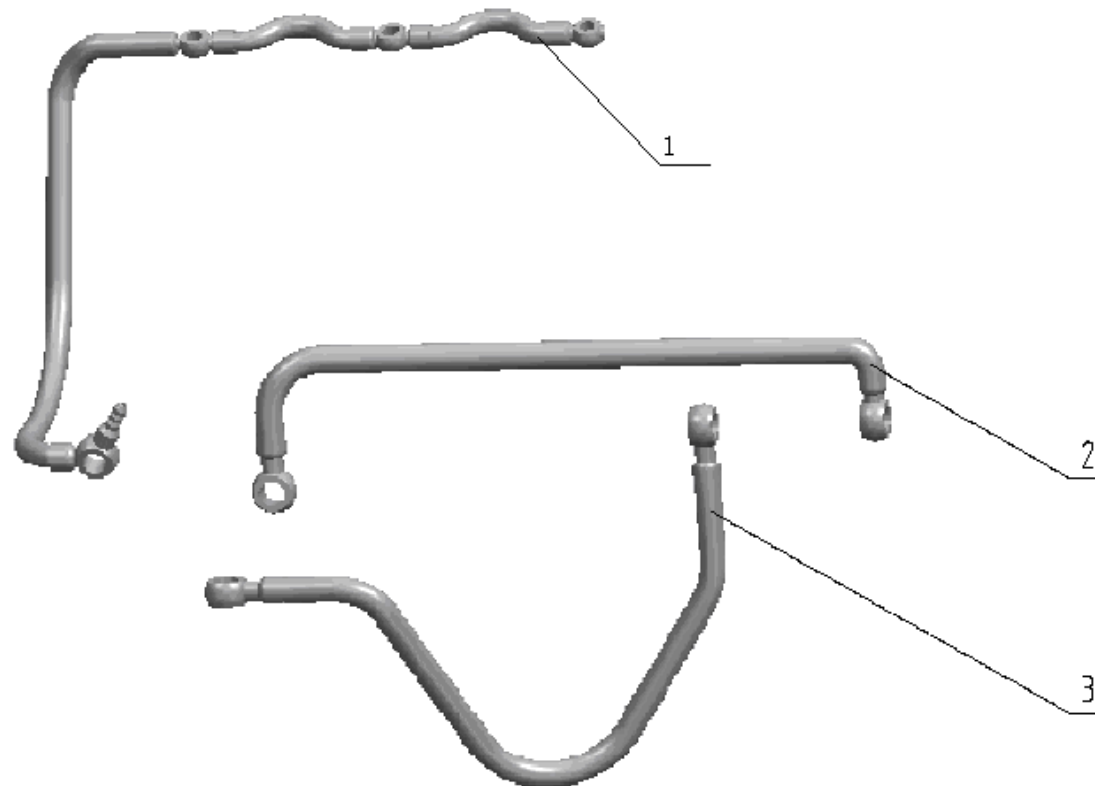

Nr	Reservdelsnr	Namn	Antal	Varunummer
1	2308002410001	Returrör	1	CS-QC380Q-002
2	2308002420000	Bränslerör	1	QC380Q-24200
3	2308002430000	Bränslerör	1	QC380Q-24300

Spridare

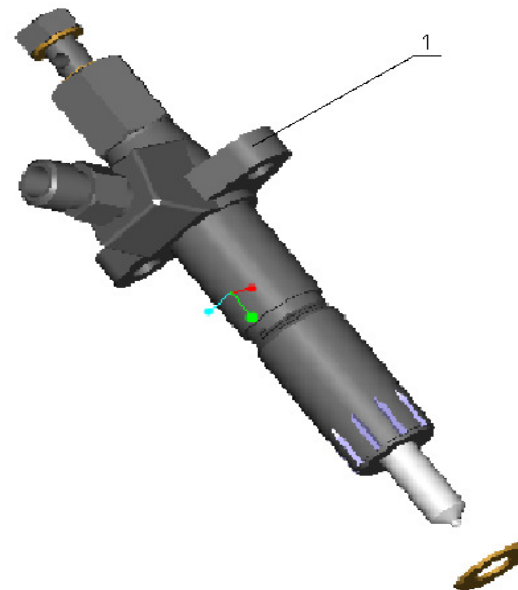

Nr	Reservdelsnr	Namn	Antal	Varunummer
1		Spridare (S523)	4	

Insprutningspump

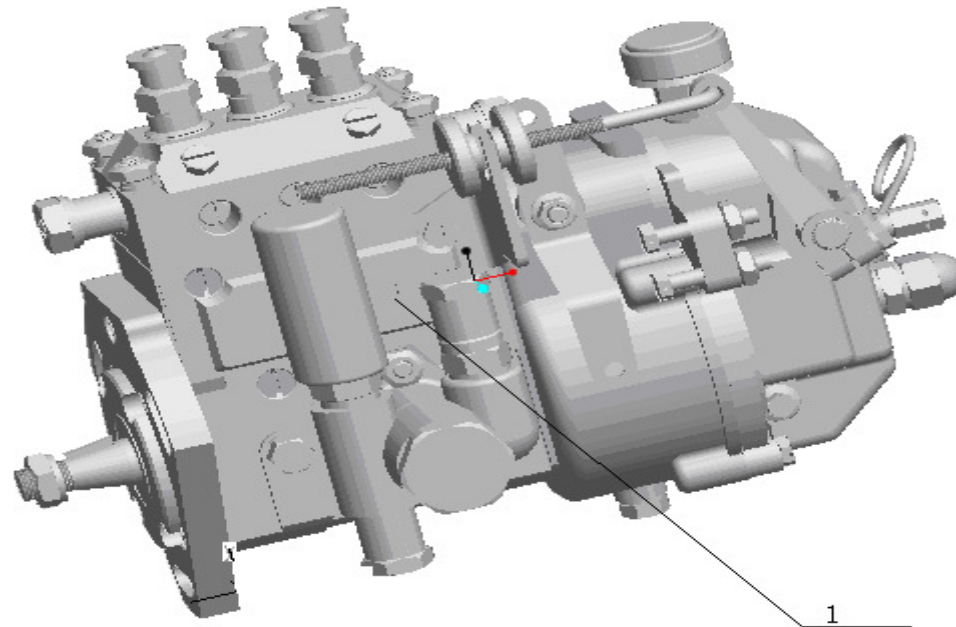

Nr	Reservdelsnr	Namn	Antal	Varunummer
1		Insprutningspump (3I415)	1	

Oljefilterhållare

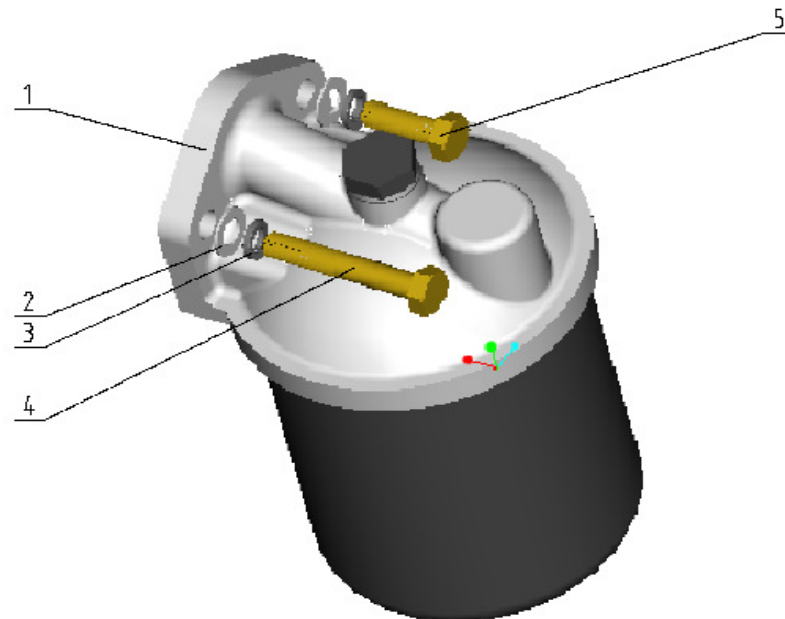

Nr	Reservdelsnr	Namn	Antal	Varunummer
1	2308002310000	Oljefilterhållare (JX0706P1)	1	QC380Q-23100
2	∅ 8	Bricka Ø8	2	GB/T97.1
3	∅ 8	Bricka Ø8	2	GB/T93
4	M8 × 50	Bult M8x50	1	GB/T5783
5	M8 × 25	Bult M8x25	1	GB/T5783

Reservdelslista

RRUN

N485D diesel motor